

NOTES:

- 304 SS case and ring
- 316 SS internals or Low-Lead Brass internals as ordered
- Dry or glycerin filled
- PC lens

REVISIONS			
REV	DESCRIPTION	DATE	APPROVAL

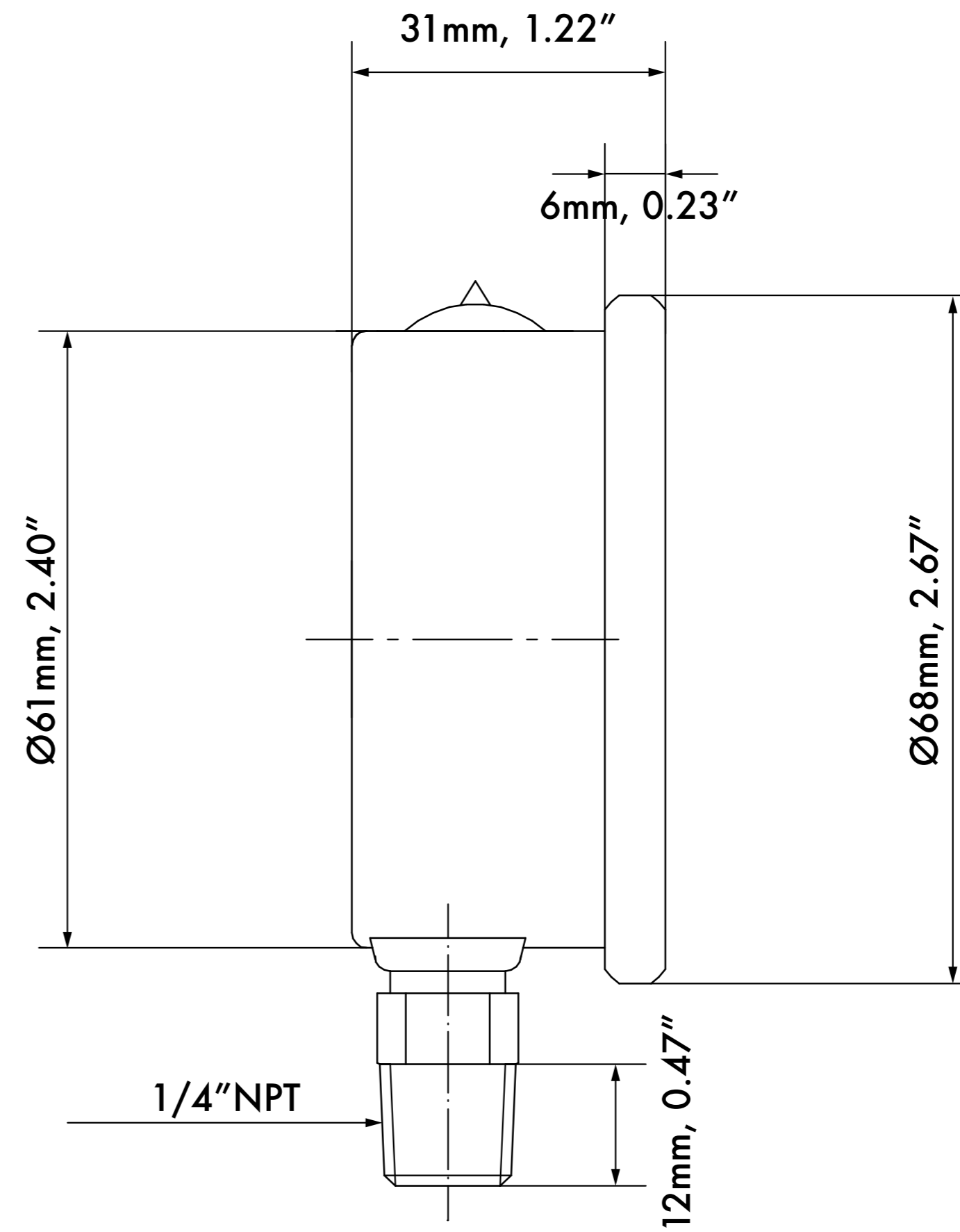
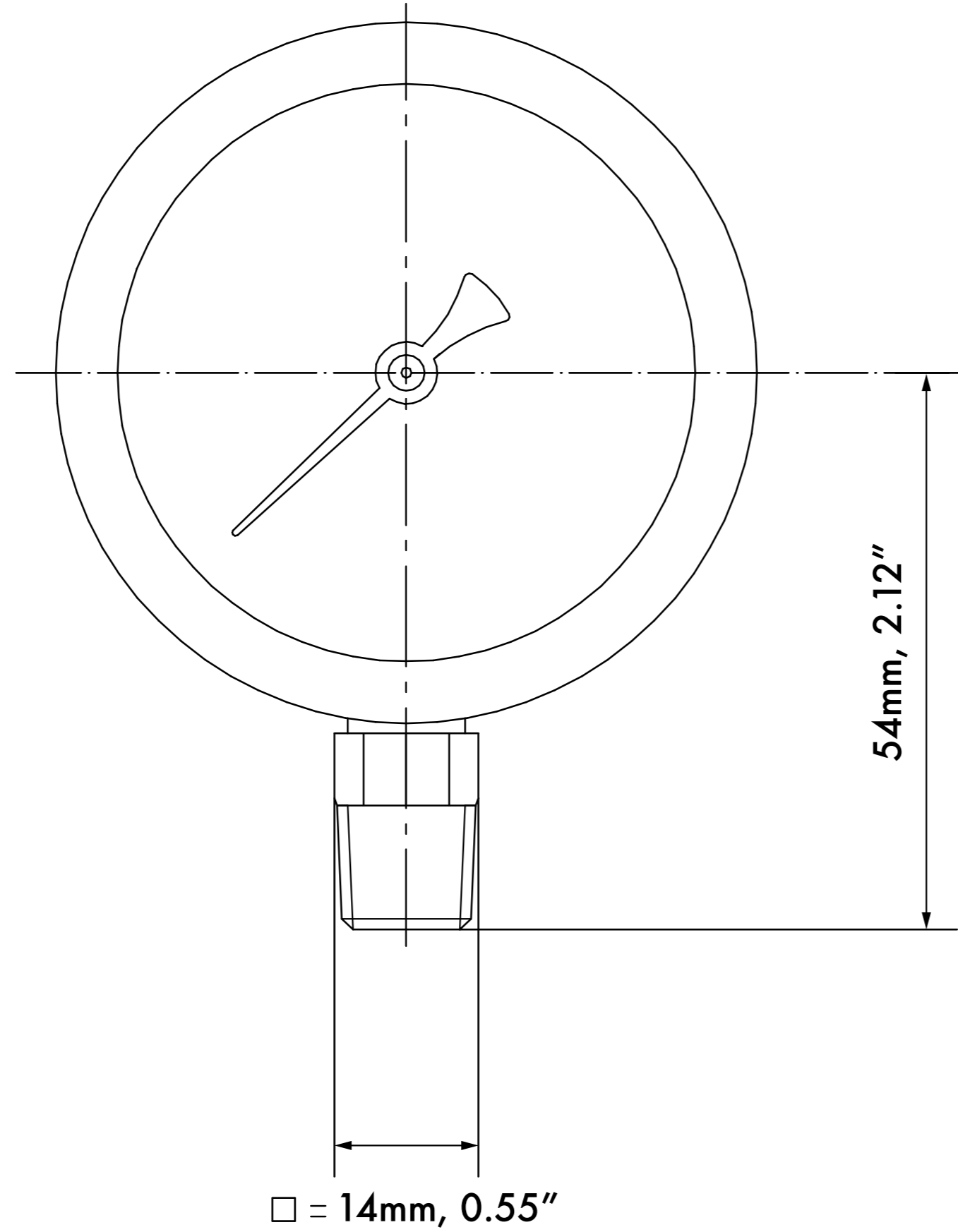

BY OR APPROVED	DATE	THIRD ANGLE PROJECTION
CHECKED:		
APPROVED: <i>B. Taylor</i>	05/21/26	



TITLE:
2.5" Crimped Ring Bottom Connection Pressure Gauge